

# BI-FOLD PLUS

SYSTEM

## Sightline

Jamb 89 mm, Meeting Stile 110 mm

## Polyamide Width

Frame 45 mm

Sash 45 mm

## Profile Thickness

Door 1.8 mm

## Glazing

Max. 48 mm, Min. 25 mm

## Maximum Sash Dimensions

Width (L) 1200 mm, Height (H) 3000 mm

## Maximum Sash Weight

120 kg

Consult maximum weight and dimensions according to typologies



BI-FOLD PLUS SYSTEM





Separate environments and unify spaces with this Bi-fold door system with an 80 mm deep frame. This evolution of the Bi-fold series offers an excellent thermal and acoustic performance, thanks to its 45 mm thermal break and a glazing capacity up to 48 mm.

Besides, it presents a slim central section of 110 mm, which maximizes the glazed surface, filling the interior spaces with natural light.



- High thermal & acoustic performance
- Maximized glazed surface
- Double bearing system with a gimbal stabiliser
- Faster manufacturing
- High security

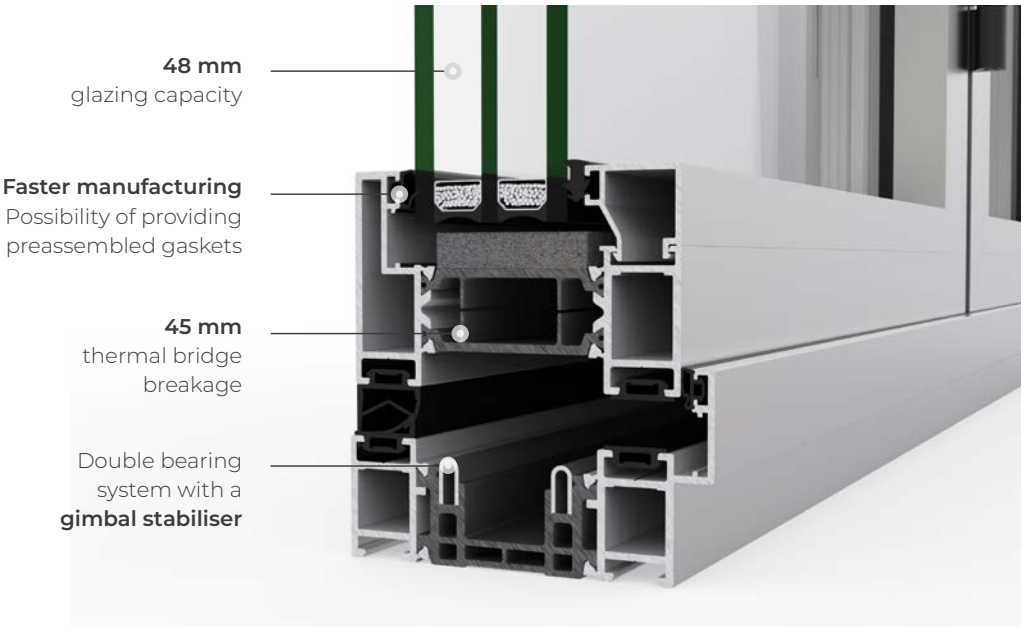

BFRC Rating kWh/(m²·yr)	
≥20	A ++
>10 to 20	A +
0 to <10	A ✓
-10 to <0	B
-20 to <-10	C
-30 to <-20	D
-50 to <-30	E
Double glazing	

BFRC Rating kWh/(m²·yr)	
≥20	A ++ ✓
>10 to 20	A +
0 to <10	A
-10 to <0	B
-20 to <-10	C
-30 to <-20	D
-50 to <-30	E
Triple glazing	



FEATURES			
U value		Double glazing * Uw from 1.2 (W/m²K)	Triple glazing * Uw ≥ 0.8 (W/m²K)
Air permeability		Class 4	
Water tightness		Class E750	
Wind resistance		Class C3	
Repeated openings and closings		50,000 cycles (Main swing door)	25,000 cycles (Even sashes)
Security test		PAS24 ✓	Passed

\* Double glazing Ug=1.0 / Triple glazing Ug=0.5

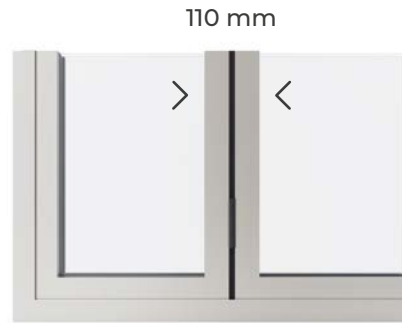

Security test: 3 sashes reference test. Configuration 321 2.70 x 2.50 m  
AWW TEST. Resistance to repeated openings and closings: EN 1191, 3 sashes reference test.  
Configuration 321 3.73 x 2.50 m

#### DRAINAGE SUBCILLS

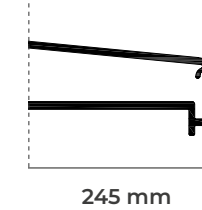
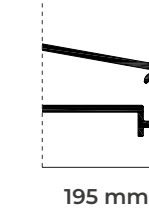
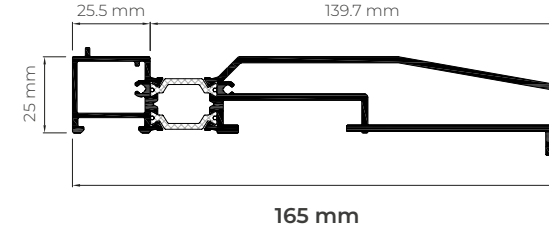
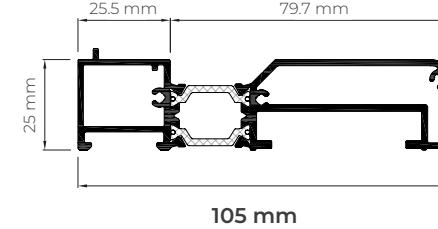

#### PROFILES WITH PRE-ASSEMBLED GASKET

##### Sash

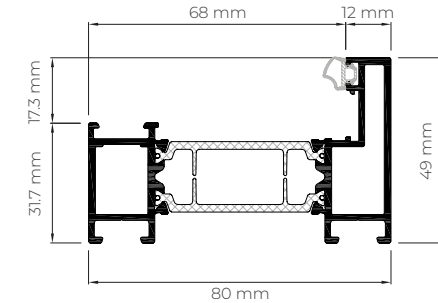

##### Outer Frame

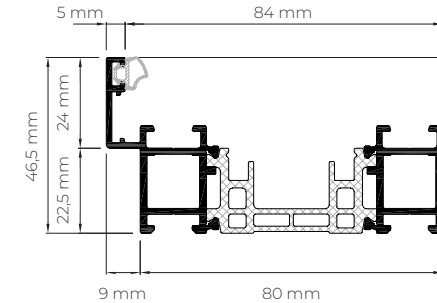

##### Glazing beads

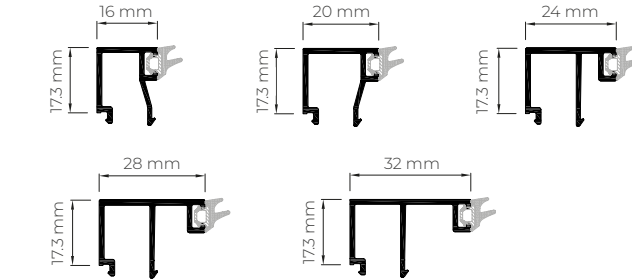

#### HEAD EXTENSION

##### Head Extension 25 mm

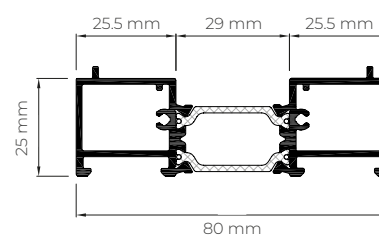

##### Head Extension 37 mm

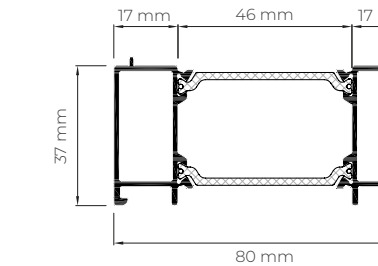

#### OPENING POSSIBILITIES

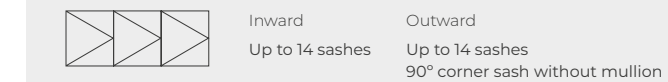

#### POSSIBILITIES

